

Veterinary Medicine Building and Ag Library

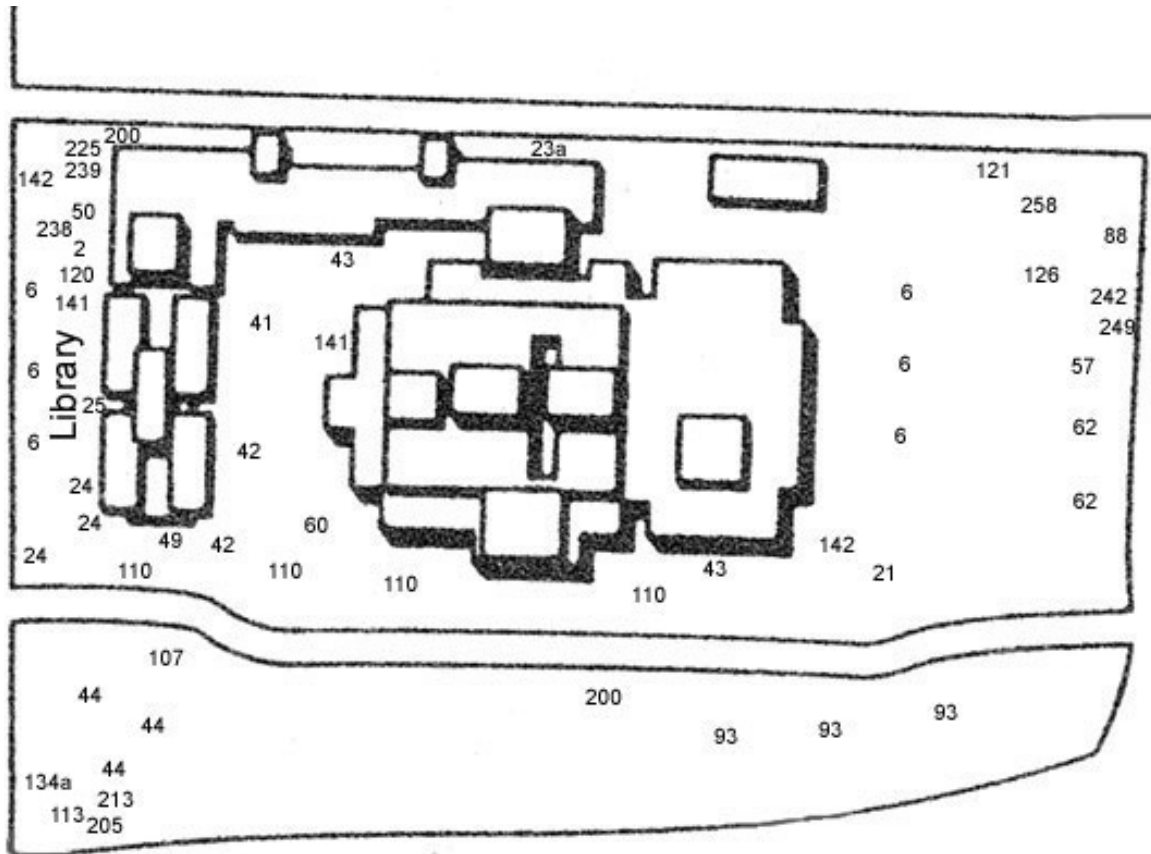

Plant List (updated Summer 2002)

- 2. *Acer palmatum* - Japanese Maple
- 6. *Acer rubrum* - Red Maple
- 21. *Cercis canadensis* - Eastern Redbud
- 23a. *Chionanthus virginicus* - White Fringetree
- 24. *Cladrastis kentukea* - American Yellowwood
- 25. *Cornus florida* - Flowering Dogwood
- 41. *Koelreuteria bipinnata* - Bougainvilla Raintree
- 42. *Koelreuteria paniculata* - Paniced Goldenraintree
- 43. *Lagerstroemia indica* - Crapemyrtle

44. *Liquidambar styraciflua* - Sweetgum
49. *Malus x cvs.* - Crabapple
50. *Metasequoia glyptostroboides* - Dawn Redwood
57. *Prunus serrulata* 'Kwanzan' - Kwanzan Japanese Cherry
60. *Pyrus calleryana* 'Bradford' - Bradford Pear
62. *Quercus acutissima* - Sawtooth Oak
88. *Cryptomeria japonica* - Japanese Cryptomeria
93. *Ilex x attenuata* 'Fosteri' - Foster's Hybrid Holly
107. *Pinus strobus* - White Pine
110. *Pinus thunbergii* - Japanese Black Pine
113. *Pseudotsuga menziesii* - Douglasfir
120. *Acer palmatum dissectum* - Cut-leaf Japanese Maple
121. *Aesculus parviflora* - Bottlebrush Buckeye
126. *Buddleia davidii* - Butterfly-bush
- 134a. *Cornus mas* - Corneliancherry Dogwood
141. *Euonymus alatus* 'Compactus' - Dwarf Winged Euonymus
142. *Forsythia x intermedia* - Border Forsythia
200. *Euonymus kiautschovicus* 'Manhattan' - Manhattan Euonymus
205. *Ilex cornuta* 'Burfordii' - Burford Chinese Holly
213. *Ilex x* 'Nellie R. Stevens' - Nellie R. Stevens Holly
225. *Juniperus horizontalis* 'Douglasii' - Douglas Juniper
238. *Nandina domestica* - Heavenly Bamboo
239. *Nandina domestica* 'Harbor Dwarf' - Harbor Dwarf Nandina

242. *Photinia x fraseri* - Fraser Photinia

249. *Pyracantha coccinea* - Scarlet Firethorn

258. *Viburnum rhytidophyllum* - Leatherleaf Viburnum