

# Morgan Hall

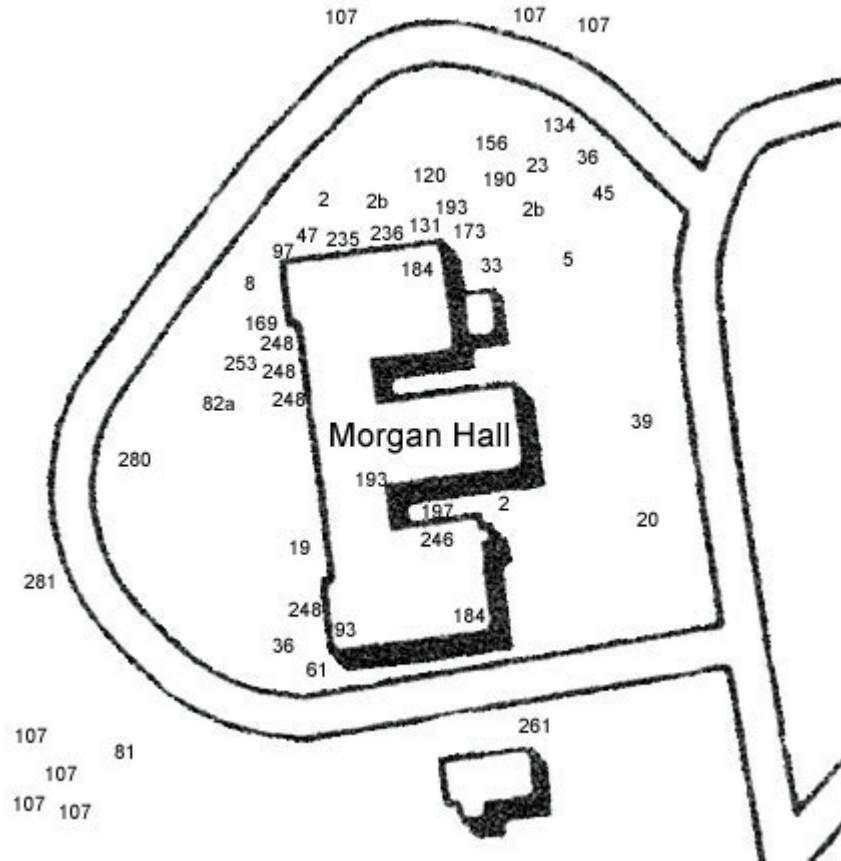

## Plant List (updated Summer 2002)

- 2. *Acer palmatum* - Japanese Maple
- 2b. *Acer japonicum* - Fullmoon Maple
- 5. *Acer platanoides* - Norway Maple
- 8. *Acer saccharum* - Sugar Maple
- 19. *Cercidiphyllum japonicum* - Katsuratree
- 20. *Celtis occidentalis* - Hackberry
- 23. *Chionanthus retusus* - Chinese Fringetree
- 36. *Ginkgo biloba* - Maidenhair Tree
- 39. *Juglans nigra* - Black Walnut

45. *Liriodendron tulipifera* - Tulip Poplar
47. *Magnolia x soulangiana* - Saucer Magnolia
61. *Pyrus calleryana* 'Bradford' - Bradford Pear
81. *Tilia tomentosa* - Silver Linden
- 82a. *Ulmus parvifolia* - Lacebark Elm
93. *Ilex x attenuata* 'Fosteri' - Foster's American Holly
107. *Pinus strobus* - White Pine
120. *Acer palmatum dissectum* - Cut-leaf Japanese Maple
131. *Chaenomeles speciosa* - Floweringquince
134. *Cornus alba* - Tartarian Dogwood
156. *Lonicera fragrantissima* - Winter Honeysuckle
169. *Spiraea x bumalda* 'Anthony Waterer' - Anthony Waterer Spirea
173. *Syringa vulgaris* - Common Lilac
184. *Abelia x grandiflora* - Glossy Abelia
190. *Buxus sempervirens* - Common Boxwood
193. *Chamaecyparis obtusa* 'Nana' - Dwarf Hinoki Falsecypress
197. *Danae racemosa* - Alexandrian-laurel
235. *Mahonia aquifolium* - Oregon Hollygrape
236. *Mahonia bealei* - Leatherleaf Mahonia
246. *Pieris japonica* - Japanese Pieris
248. *Prunus laurocerasus* - Cherrylaurel
253. *Rhododendron obtusum* – Japanese Azalea
261. *Ulmus americana* - American Elm

280. *Crataegus viridis* 'Winter King' - Winter King Green Hawthorne

281. *Viburnum x pragense* - Prague Viburnum